

INSTALLATION IS EASY

1

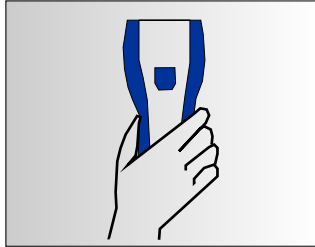

Find Studs

2

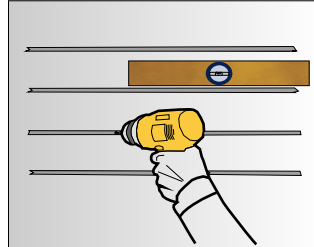

Hang Slatwall

3

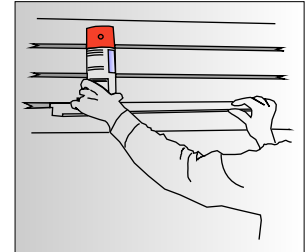

Get Organized

Tools



Pencil



Tape Measure



Safety Goggles



Level



Flat Head Screws

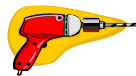

Drill



Stud Finder



Saw



Installation Information

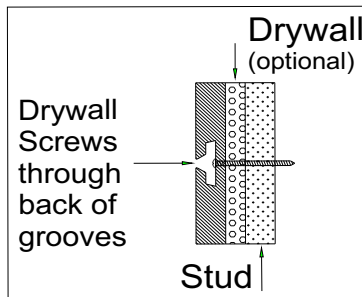

1. Handle with care.
2. Use a stud finder to locate and mark studs.
3. Use a level to draw a straight line at the desired height.
4. If cutting is required, cut the panels with a power saw. The saw blade should enter the grooved side of the panel.
5. Use 1½" screws if attaching direct to studs. Use 2" screws if installing over drywall into studs.
6. Fasten the screws into every other groove, each stud - 16" on-center studs are recommended.
7. Panel edges can be trimmed with ¾" square or rounded moldings. Trim and molding options are available at the DIY Centers.
8. Clean with soft rag.

Load level capacities

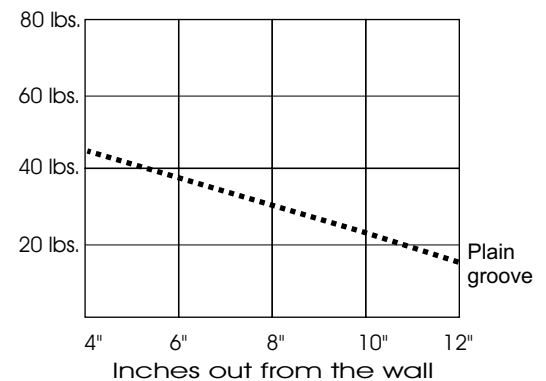

This chart is based on 3" o.c. or greater grooves using a single bracket on properly installed panels.

The load levels shown above provide a recommended guideline for weight carrying capacities. The data is based on:

- A single bracket, or accessory
- Plain groove Slatwall - without metal inserts
- Properly placed / not dropped items
- Brackets/accessories spaced every 12" - 16"

Note - when installing a shelf utilizing shelf brackets, we recommend the use of the shelf support arms - with spacing between assemblies every 16".