

INSTALLATION IS EASY

1

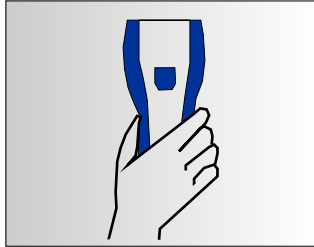

Find Studs

2

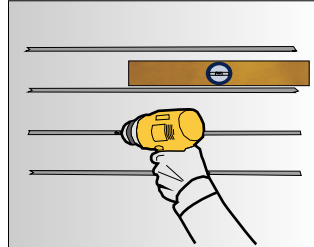

Hang Slatwall

3

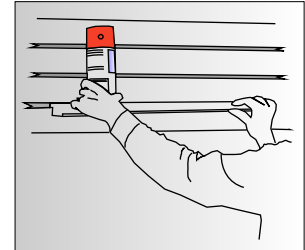

Get Organized

Tools Required



Pencil



Tape Measure



Safety Goggles



Level



Flat Head Screws

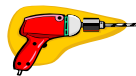

Phillips Screw Driver



Stud Finder



Circular Saw



Installation Information

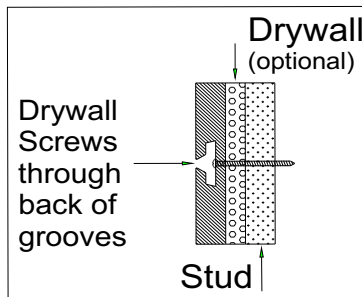

1. Handle with care. Do not drag panels.
2. Use a stud finder to locate and mark studs.
3. Use a level to draw a straight line at the desired height.
4. Cut the panels with a power saw. The saw blade should enter the grooved side of the panel.
5. Panels come with half grooves on the top and bottom for stacking.
6. It is recommended to use firing strips when attaching panels to cement walls.
7. Use 1½" screws if attaching direct to studs. Use 2" screws if installing over drywall.
8. Fasten the screws into every other groove, each stud - 16" on-center studs are recommended.
9. Panel edges can be trimmed with ¾" square or rounded moldings. Trim and molding options are available at the DIY Centers.
10. Clean with soft rag - avoid using excess moisture.

Maximum load level capacities

This chart is based on 3" o.c. or greater grooves using a single bracket on properly installed panels.

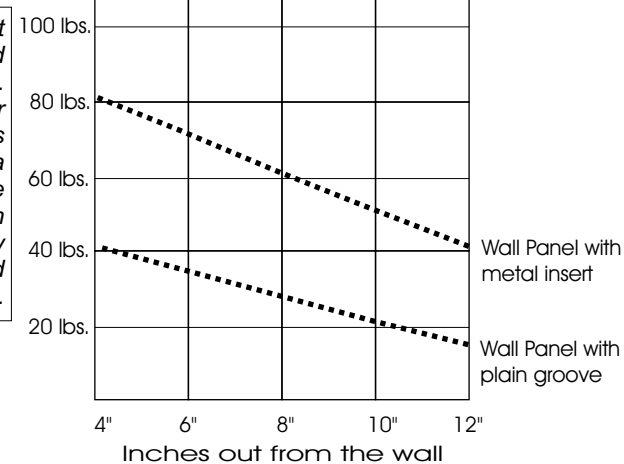

- The load levels shown above are based on properly installed panels over drywall and onto a stud-wall.
- We caution against:
 - overloading any single groove.
 - hang-bars and waterfalls overloaded with weight.
 - heavier weights near the edges.
 - not using panel adhesive or enough screws to secure the panel to the wall.
- If hanging strength is an issue, please contact us to discuss alternatives prior to placing your order.